



**DESIGN
TO INNOVATE**
Our chains are used
in many areas
due to the wide range
of products and the
possibility to customise
them for your every need



MKTGEN000007 - © COPYRIGHT BREVETTI STENDALTO - 2016 - EN

**brevetti
stendalto**

**brevetti
stendalto**
DYNAMIC CABLE PROTECTION

Brevetti Stendalto S.p.A.
20900 Monza
Viale Giovanni Battista Stucchi 66/8
Tel. +39 039 20.49.01
Fax +39 039 83.42.50
E-mail: info@brevettistendalto.it

WWW.BREVETTISTENDALTO.COM



IR-CHAIN
System



iR-CHAIN

INVISIBLE ROLLING SYSTEM

Brevetti's IR-System is the evolution of the sliding chain concept. This technology has been developed after years of data collection and analysis from real applications around the globe.

The Brevetti Design Engineers succeeded in further improving the well-known advantages of the Brevetti cable chain systems in port technologies with the innovative IR-Block Set.



QR-Code
Watch the video with
your Smartphone!

iR-BENEFITS

- ✓ **Reliable**
IR-chain is the evolution of M series, well recognized for its performance and installations all over the world.
- ✓ **Low push-pull force needed**
IR-chains have been designed to reduce the minimum force required to set the system in motion.
- ✓ **Smooth movement**
Invisible rolling system eliminates the interference between rollers. On the upper chain portion the rollers are retracted while on the lower portion they are protruded to encrease the performance all links have the same pitch.
- ✓ **Extended lifetime**
The engineered rolling solution avoids wearing and extends the life of the system.
- ✓ **Harsh environment**
Highest priority has been placed to design a reliable solution for harsh environments, including dust and mud. Specific openings have been properly engineered to avoid accumulation of undesired material in critical areas.
- ✓ **Perfect Alignment**
Upper part of chain always glides perfectly on the lower portion.

DYNAMIC CABLE PROTECTION

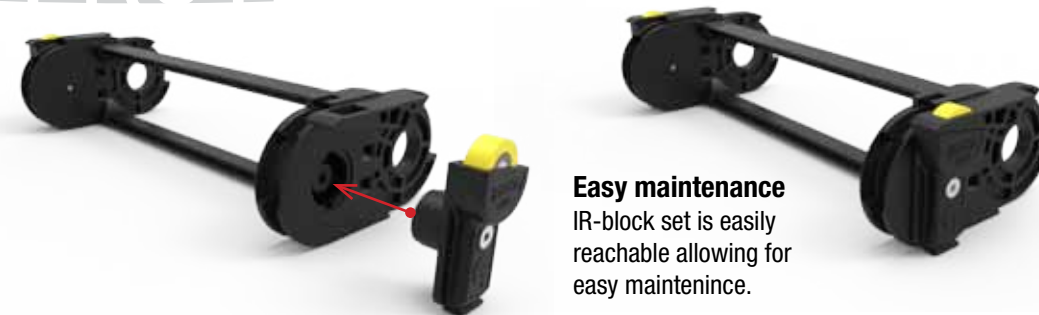

HOW THE IR-BLOCK SET WORKS

The inner mechanism makes the IR-System appear when it's needed.

When it's not needed, the IR-roller remains invisible and hidden inside the sliding surface.

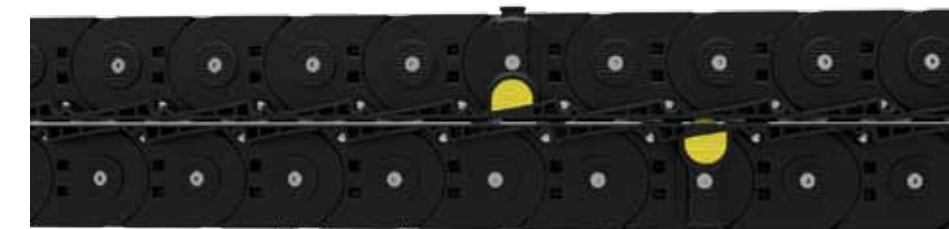
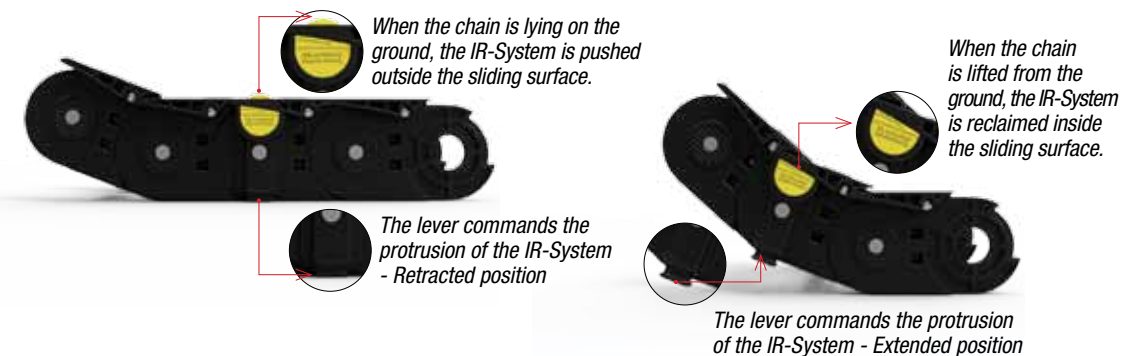

Through Brevetti's IR-System mechanism, rollers at the lower chain portion are protruded and the upper chain portion slides along a perfectly smooth surface.